

Courses and distances down Clarion River from the Black Oak Corner

- 1 ~ N. 59 1/2° W. ~ 20.5
- 2 ~ N. 46° W. ~ 10
- 3 ~ N. 35° W. ~ 12
- 4 ~ N. 19° W. ~ 30
- 5 ~ N. 5° W. ~ 15
- 6 ~ N. 10° E. ~ 53

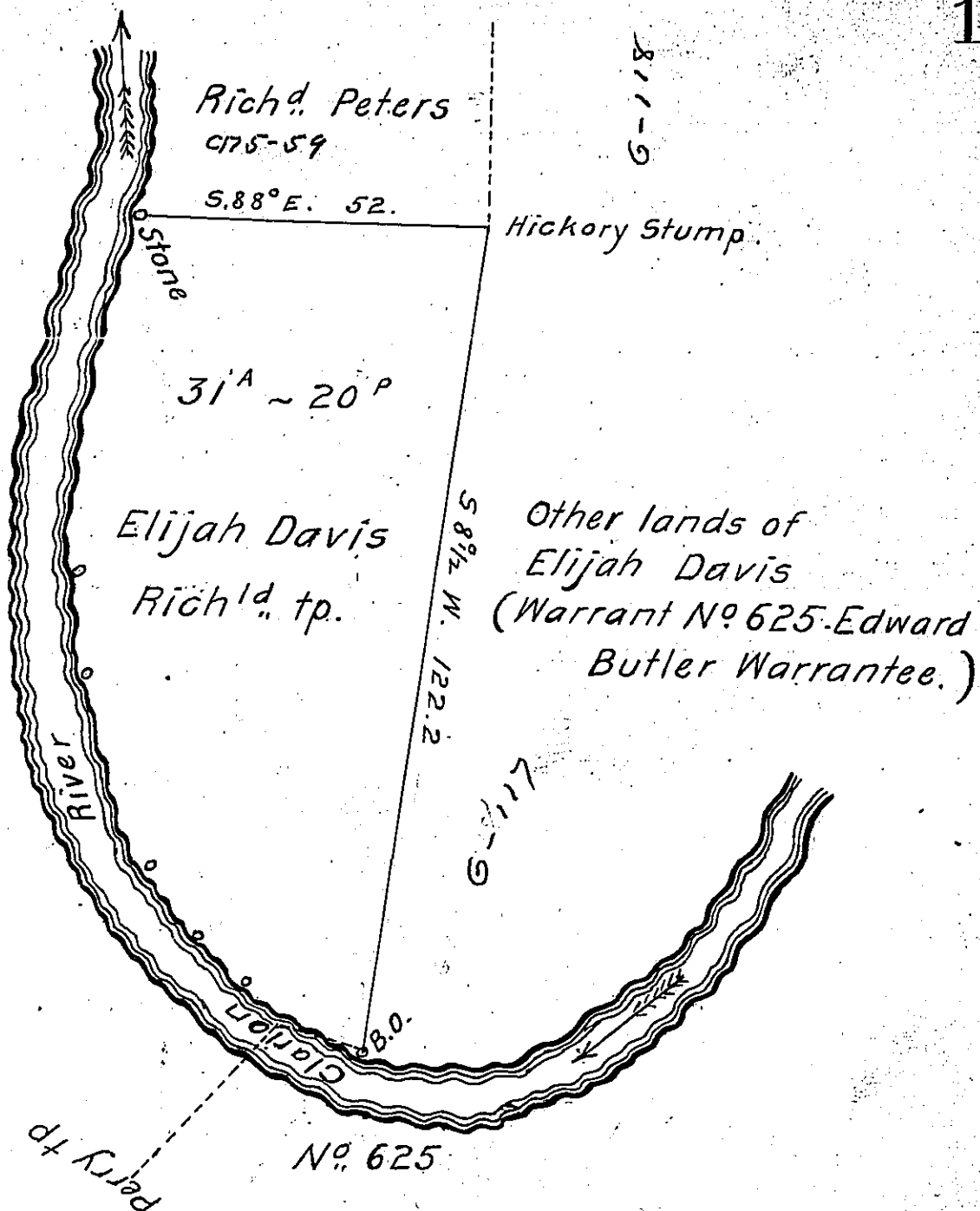

In pursuance of a Warrant dated March 10th 1847. granted to Elijah Davis,

Surveyed, June 12, 1847. to said Elijah Davis, the above described tract of land (improved) Situate on the right bank of the Clarion River in Richland township, Clarion County Pa, Containing Thirty-one acres and twenty perches and allowance of six per cent.

Hon. John Laporte }
Surveyor General }

B. J. Reid D.S.

IN TESTIMONY that the above is a copy of the original remaining on file in the Department of Internal Affairs of Pennsylvania, made conformably to an Act of Assembly approved the 16th day of February, 1833, I have hereunto set my Hand and caused the Seal of said Department to be affixed at Harrisburg, this thirty first day of August 1904.

Isaac D. Pearson
Secretary of Internal Affairs.